



# CANCER RISK TEST

## SAMPLE INSTRUCTIONS

### IMPORTANT



1. No eating, drinking, smoking or chewing gum for 30 minutes before your saliva sample.

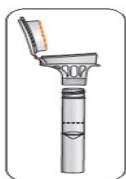

2. Do not remove the plastic film from the funnel lid. When you close the funnel lid, stabilizing liquid will flow into the tube and mix with your saliva.



3. It may take a few minutes (2 to 5 minutes) to provide the amount of saliva needed to reach the fill line.

### Sample collection

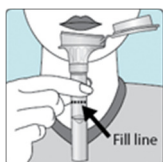

1. Spit into funnel until the amount of liquid saliva (not bubbles) reaches the fill line shown in the picture.



2. Hold the tube upright with one hand. Close the funnel lid with the other hand by firmly pushing the lid until you hear a loud click. The liquid in the lid will be released into the tube to mix with the saliva. Make sure that the lid is closed tightly.

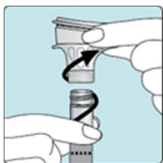

3. Hold the tube upright. Unscrew the funnel from the tube.

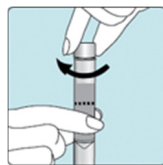

4. Use the small cap to close the tube tightly.



5. Shake the capped tube for 5 seconds. Discard the funnel. Put the tube in the original plastic holder.

### Verzending staal

1. Complete the submission form. Submission form must be signed by patient.

2. Place the tube with plastic holder back in the original white box.

Send the box to GENDIA.

GENDIA  
Emiel Vloorsstraat 9  
2020 ANTWERPEN  
BELGIE



Contact us if you have any questions : [info@GENDIA.net](mailto:info@GENDIA.net)

or + 32 33 03 08 01.